

**AC Fan Motors**

# Dyna Ace $\phi 172$ mm

Dyna Ace

**High-air-flowrate, high-static-pressure type and best suited for industrial equipment and computer peripherals**

**General specifications**

- Motor construction .....Capacitor motor
- Motor protection system .....thermal protection
- Dielectric strength .....50/60 Hz, 1500 VAC, 1 minute  
(between input terminal and frame)
- Operating voltage range .....+10%
- Plug cord For UL/CSA 489-084 (L10, L21)  
489-086 (L10, L21)  
※For the power cord, see page 113.



**51** mm thick (Sidecut type :  $\phi 172 \times 150$ )

**Specifications** (Operating thermally range  $-30^{\circ}\text{C}$  to  $+60^{\circ}\text{C}$ )

Model	Voltage (V)	Frequency (Hz)	Input (W)	Current (A)	Bound current (A)	Rotating speed ( $\text{min}^{-1}$ )	Air flow ( $\text{m}^3/\text{min}$ ) (CFM)	Static pressure (Pa)	Noise (dB[A])	Mass (g)
109S301	100	50/60	27/25	0.33/0.25	0.65/0.64	2900/3500	5.3/6.4 187.3/226.1	147/196	51/56	900
109S304	115			0.29/0.22	0.55/0.54					
109S302	200			0.16/0.13	0.33/0.32					
109S303	230			0.14/0.11	0.28/0.27					

**Typical air flow and static pressure characteristics**

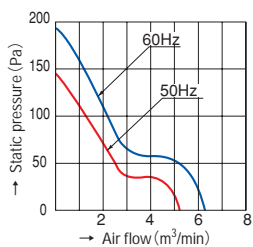

- 109S301
- 109S304
- 109S302
- 109S303

Dimensions (unit : mm)

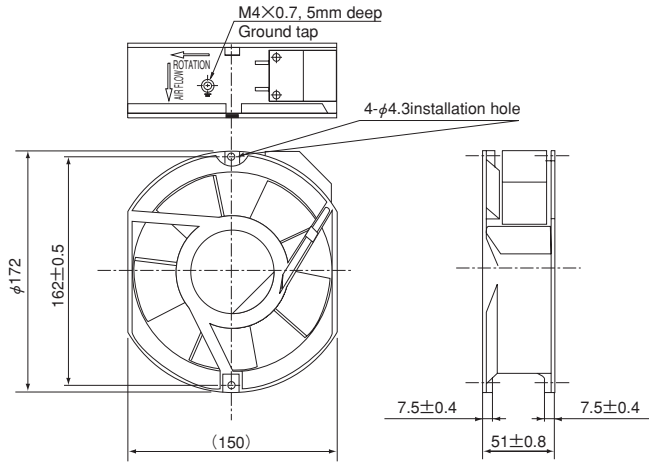

Reference dimensional diagram for installation holes (unit : mm)

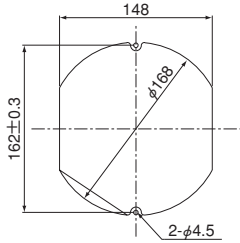

Wiring diagram

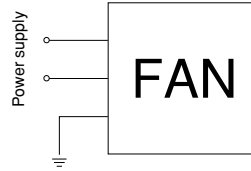

**SANYO DENKI**

1-15-1, Kita-otsuka, Toshima-ku, Tokyo 170-8451, Japan. PHONE : +81 3 3917 5151  
Home Page: <http://www.sanyodenki.co.jp>

Rev.B