

DC Fan

80mm

San Ace 80

15mm thick, 20mm thick, 25mm thick
 25mm thick (San Cooler), 32mm thick
 38mm thick (GV type), 38mm thick (G type)



General Specifications With a pulse sensor Specifications for pulse sensors ⇔ Refer to Page 239

*Please inquire about other specifications.

- Material Frame: Plastics (Flammability: UL94V-0),
 Impeller: Plastics (Flammability: UL94V-1)
- Life Expectancy Varies for each model (L10: Survival rate: 90% at 60°C ,
 rated voltage, and continuously run in a free air state)
- Lead Wire ⊕red ⊖black (Sensor) yellow
- Storage Temperature -30°C to +70°C (Non-condensing)

80mm × 25mm thick [Mass : 110g]

Specifications The numbers in () represent ribless models.

Model No.	Rated Voltage (V)	Operating Voltage Range (V)	Rated Current (A)	Rated Input (W)	Rated Speed (min ⁻¹)	Air Flow (m ³ /min) (CFM)		Static Pressure (Pa) (inchH ₂ O)		SPL (dB[A])	Operating Temperature Range (°C)	Life Expectancy (h)	
109R0805F401(4011)	5	4.5 to 5.5	0.25	1.25	2,600	0.92	32.5	28.4	0.114	26	-10 to +70	60,000	
109R0805M401(4011)			0.17	0.85	2,350	0.83	29.3	22.5	0.090	23			
109R0812G401(4011)	12	10.8 to 13.2	0.37	4.44	4,500	1.50	53.0	80.4	0.323	40	-10 to +60	40,000	
109R0812S401(4011)		6 to 13.8	0.18	2.16	3,400	1.20	42.4	48.0	0.193	34			
109R0812H401(4011)			0.13	1.56	2,900	1.03	36.4	35.3	0.142	29			
109R0812F401(4011)			0.11	1.32	2,600	0.92	32.5	28.4	0.114	26			
109R0812M401(4011)			0.09	1.08	2,350	0.83	29.3	22.5	0.090	23			
109R0812L401(4011)			7 to 13.8	0.06	0.72	1,850	0.65	23.0	14.7	0.059			20
109R0824G401(4011)			20.4 to 26.4	0.20	4.80	4,500	1.50	53.0	80.4	0.323			40
109R0824S401(4011)	12 to 27.6	0.10	2.40	3,400	1.20	42.4	48.0	0.193	34				
109R0824H401(4011)		0.07	1.68	2,900	1.03	36.4	35.3	0.142	29				
109R0824F401(4011)		0.06	1.44	2,600	0.92	32.5	28.4	0.114	26				
109R0824M401(4011)		0.05	1.20	2,350	0.83	29.3	22.5	0.090	23				
109R0824L401(4011)		14 to 27.6	0.04	0.96	1,850	0.65	23.0	14.7	0.059	20			
109R0848K401(4011)	48	40.8 to 55.2	0.10	4.80	4,600	1.56	55.1	88.4	0.355	41	-10 to +60	40,000	
109R0848S401(4011)			0.06	2.88	3,400	1.20	42.4	48.0	0.193	34			

Dimensions (Unit : mm)

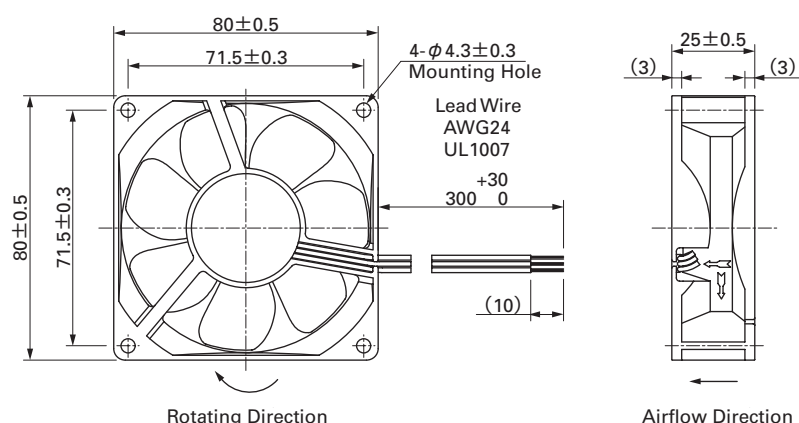

Reference dimension of mounting holes and vent opening (Unit : mm)

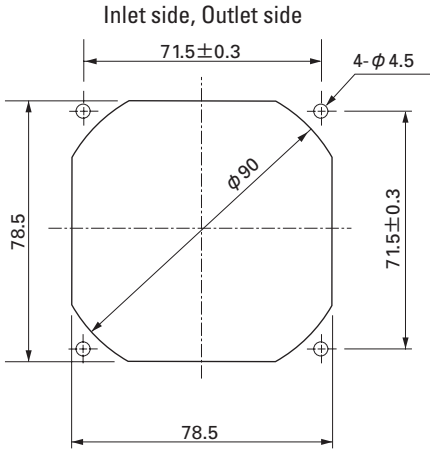

Options (Unit : mm)

Finger guards

Model : 109-049C Color : Nickel-chrome plating (silver)

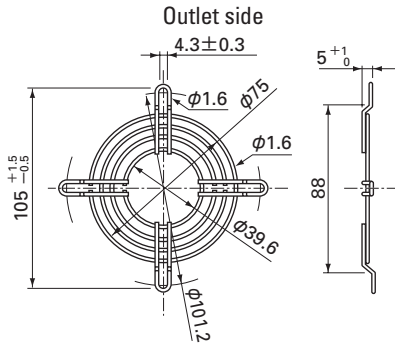

Resin finger guards

Model : 109-1002G

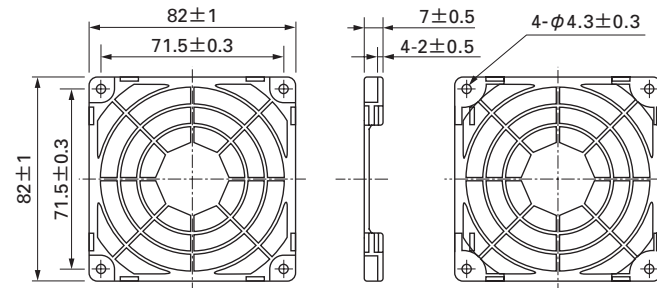

Model : 109-049E Color : Nickel-chrome plating (silver)
: 109-049H Color : Cation electropainting (black)

Inlet side, Outlet side

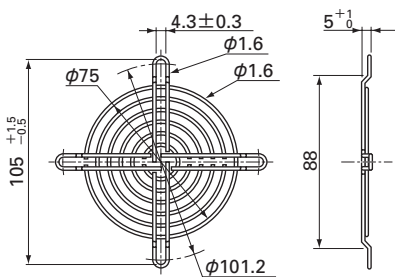

Resin filter kits

Model : 109-1002F13 (13PPI), 109-1002F20 (20PPI)
: 109-1002F30 (30PPI), 109-1002F40 (40PPI)

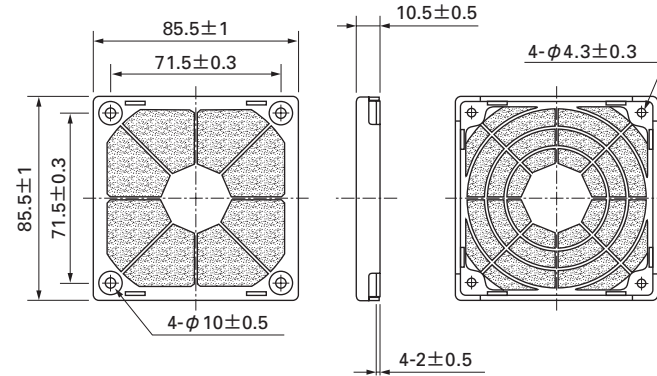

San Ace 80

80mm

80mm × 25mm thick (Mass : 110g)

Air Flow and Static Pressure Characteristics

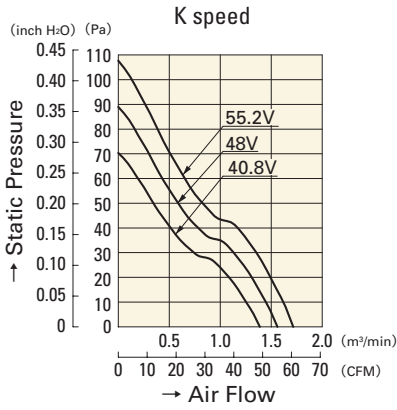

109R0848K401(4011)

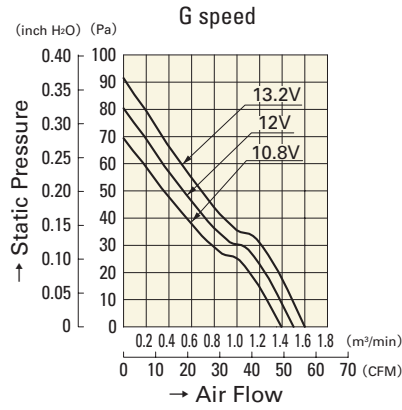

109R0812G401(4011)

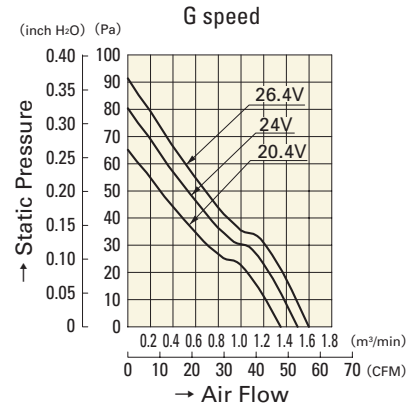

109R0824G401(4011)

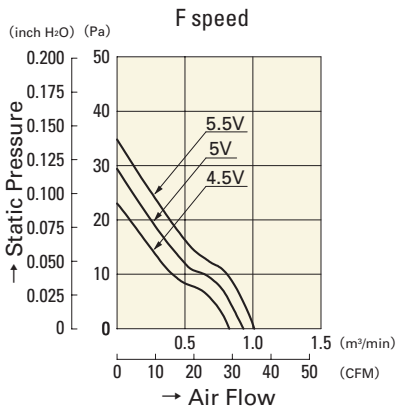

109R0805F401(4011)

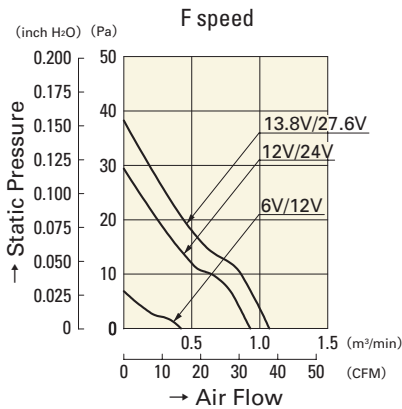

109R0812F401(4011)
109R0824F401(4011)

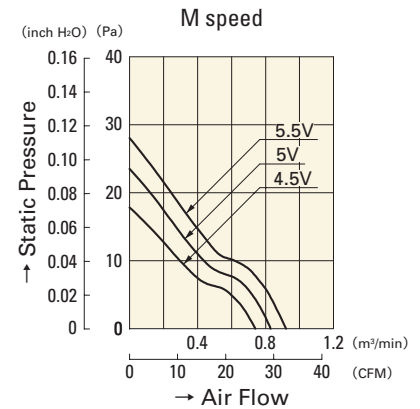

109R0805M401(4011)

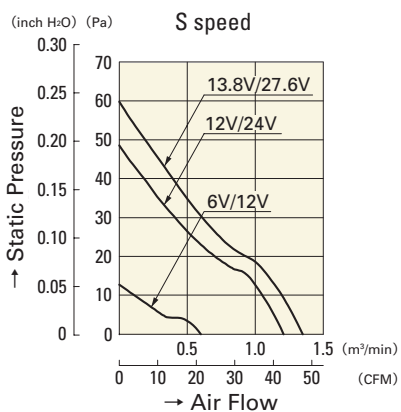

109R0812S401(4011)
109R0824S401(4011)

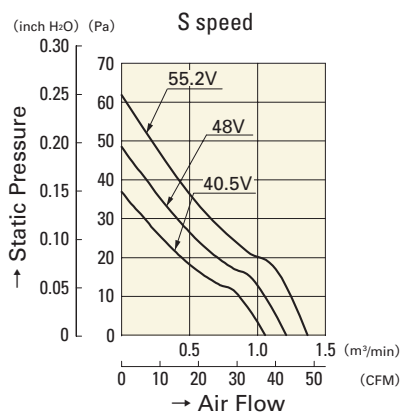

109R0848S401(4011)

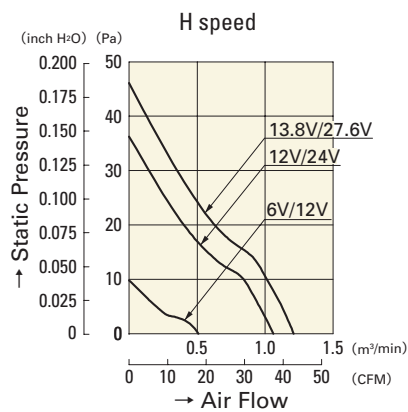

109R0812H401(4011)
109R0824H401(4011)

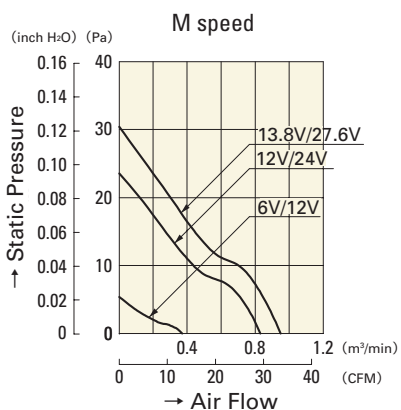

109R0812M401(4011)
109R0824M401(4011)

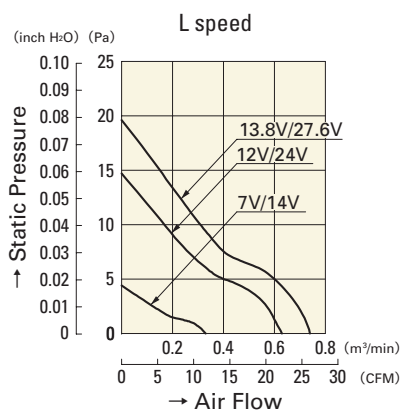

109R0812L401(4011)
109R0824L401(4011)